

# Era

# WINNEBAGO

*Touring Coach™*



## **Why Era?**

- The most affordable Mercedes-Benz® Sprinter van camper among the leading brands in North America
- Premium contemporary interior
- Incredible fuel economy
- Ultraleather™ furniture
- All-new 4x4 Chassis option
- Multiplex wall switches (70A, 70X)
- Powered patio awning with LED lighting



On the Cover: 70X Brilliant Silver Full-Body Paint

70X Paragon with Smoke/High-Gloss Dark Canvas Combo Cabinetry

## Accept No Limitations

The Class B market continues to grow, in large part due to the success of the Era®. Its combination of fuel efficiency, maneuverability, and high-end features has introduced a whole new set of enthusiasts to the van-style RV. With its Mercedes-Benz® diesel engine, driving your Era is a pure joy. Arrive at your destination safely and on time with the help of the Radio/Rearview Monitor with 6" touchscreen and the available Rand McNally RV GPS. Each floorplan offers a full-featured galley and swivel cab seats that increase your functional living space

while parked. Inside, you'll find dimmable LED ceiling lights (70A, 70X), MCD blackout roller shades, Corian® countertops, and a rear screen wall (70A, 70X). An awning with LED lighting will keep the outdoor fun going well into the night. Take your travels off the trails with the all-new Era 4x4; the first Sprinter-based off-road RV from Winnebago. Enjoy all of the same amenities, 5,000-lb. towing capacity, and two additional inches of ground clearance. For versatility and style with Winnebago's legendary construction standards, choose the Era.



### Recognized Quality

The Recreation Vehicle Dealer Association annually rates RV manufacturers and awards the Quality Circle Award to manufacturers that provide exceptional products, service and support. Winnebago Industries is proud to be the only manufacturer that has received this award every year since its inception.



70X Paragon with Smoke/High-Gloss Dark Canvas Combo Cabinetry

One critical space-enhancing feature of the Era is the swivel cab seats that turn to become part of the lounge. From here you can watch TV, eat dinner at the movable pedestal table, or enjoy conversation with people sitting on the sofa/bed (70A, 70C) or passenger captain's seats (70X). Adjust the environment to fit your comfort with MCD blackout roller shades and the new Truma Combi™ Eco Plus heating system (70A, 70X) and ALDE (70C). It outperforms traditional water heater and furnace systems, and requires only one small vent through the vehicle body and is significantly quieter than a traditional furnace. Soft-closing cabinet doors (70A & 70X) with a new high-gloss finish complete the contemporary look and feel.



Enjoy a smartly-configured galley that houses a microwave oven (convection oven 70C & 70X) and range top with a glass cover. The refrigerator/freezer works on both 110-volt, LP and battery power so you'll always have cold food. A removable freezer unit in the 70A delivers additional cold storage flexibility.





70X Bed



70X Bath with New Fiberglass Surround



70X Wardrobe



70X Bath Sink

Flexibility is everything in a Class B motorhome and nowhere is that more evident than the unique sleeping spaces available in your Era. The 70A offers a true bedroom featuring the Flex Bed system. With a few simple adjustments requiring no tools, the two twin beds convert into a single queen bed. The 70C includes the Fold N Tumble sofa/bed for quick conversions in the front lounge and the 70X offers a sofa bed in the rear lounge. All models offer full bath amenities while the 70C pushes the Class B bathroom concept even further with a separate glass-door shower.



Dash

Built on a peppy Mercedes-Benz Sprinter chassis, the Era has always been a joy to drive. This year we've taken it to another level with a 4x4 off-road package that delivers all the power you expect with more traction and an additional two inches of ground clearance. The available collision avoidance system makes the Era one of the safest motorhomes on the road. Enhance your trip by adding the Infotainment Center with Rand McNally GPS and touchscreen control for the CD/DVD/FM/AM stereo system.



70X Swivel Cab Seats



Powered Mirrors with Defrost



With the new 4x4 package, you might find yourself camping in places you never thought possible. Whether you're deep in the woods, down by the beach, or at a traditional campsite, the standard patio awning with LED lighting and exterior speakers make it easy to kick back and enjoy the scenery. For easy access to your gear, select the 70A that includes a rear storage compartment with a sliding tray.



70X Rear Doors



Exterior Entertainment Center



Exterior Service Center



Exterior Wash Station



Exterior Speakers



Click here to explore this floorplan's web page.

## 70A

The 70A is all about flexibility with a galley extension for meal prep and the Flex Bed system that quickly shifts from one bed into two.

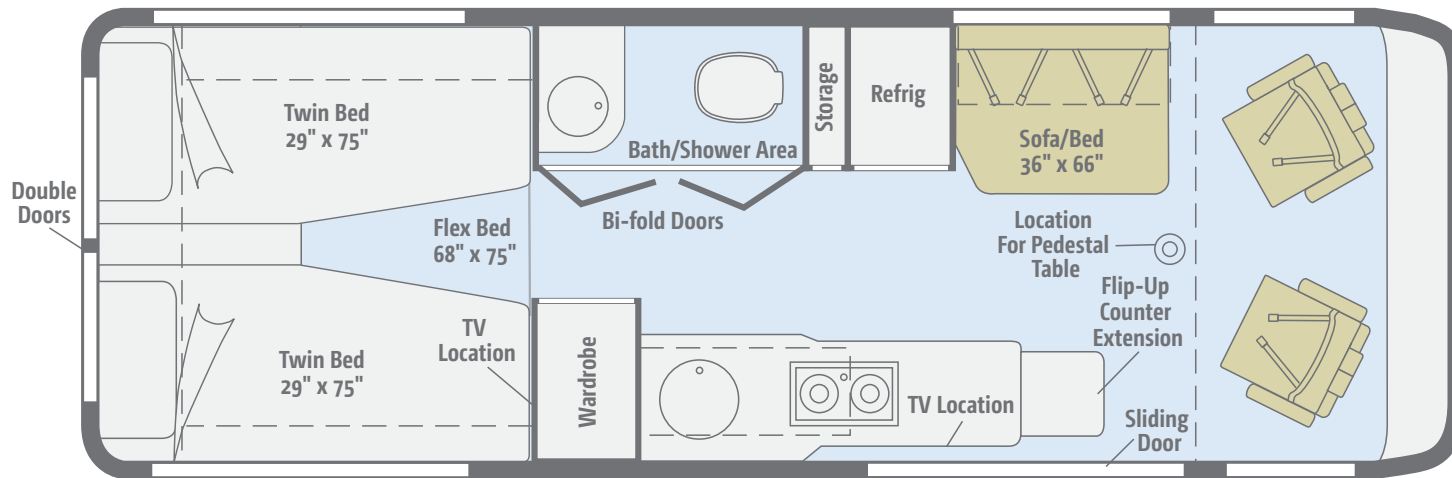

Standard  
Ultraleather



Vinyl





Click here to explore this floorplan's web page.

# 70C

A Fold N Tumble sofa/bed and a full bath with a dedicated shower make this an ideal floorplan for a couple on the go.

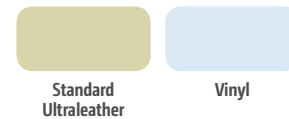
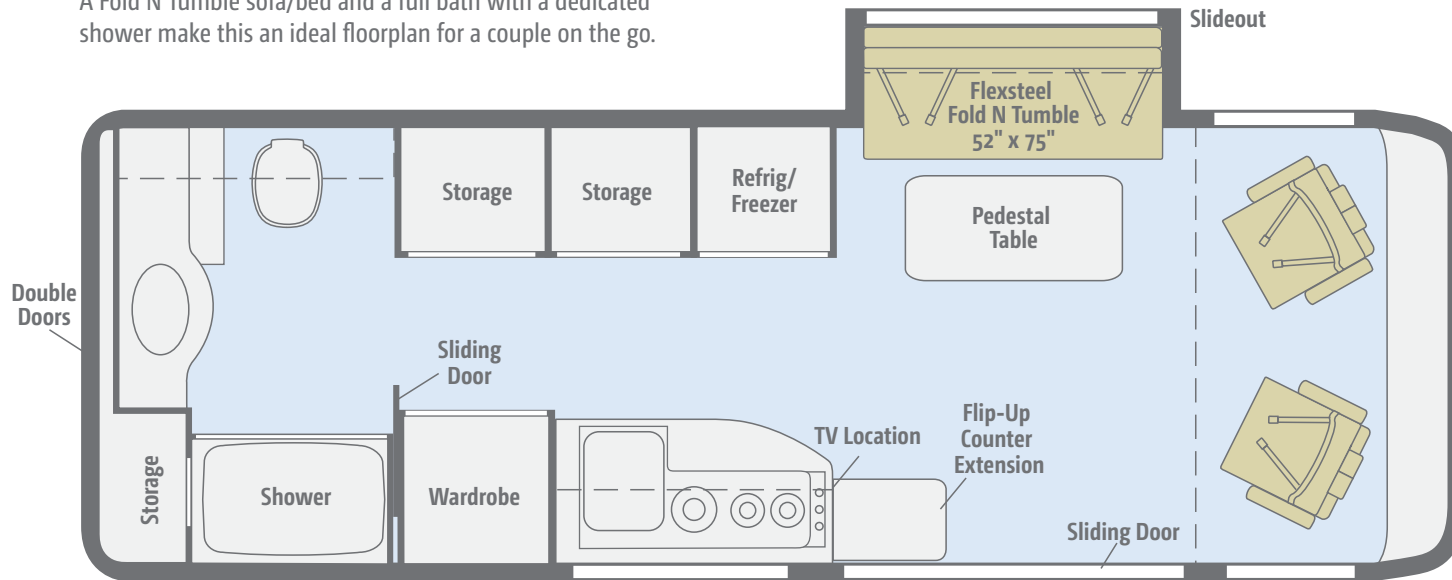

 Click here to explore this floorplan's web page.

## 70X

Four cab seats create a pleasant conversation and dining area, while the sofa/bed in the back is perfect for watching TV or catching some Zs.

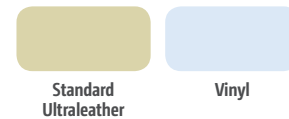
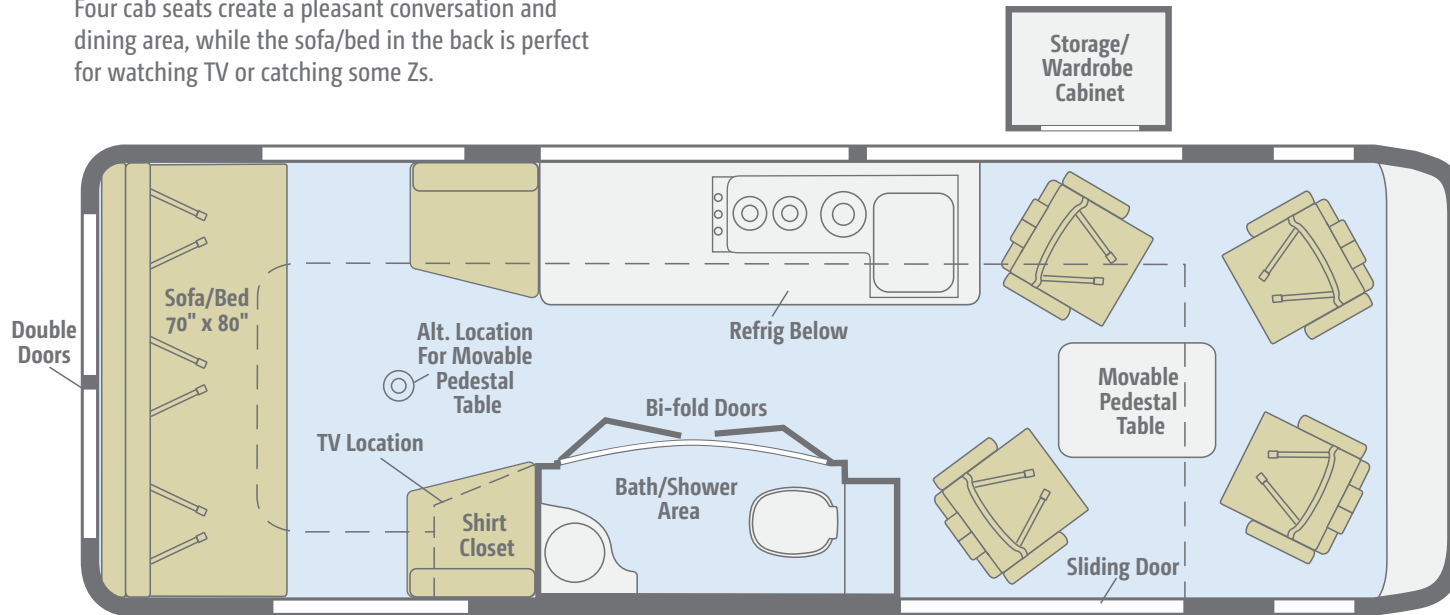

Choose from three fabric collections.

## Paragon (70A, 70X)



Ultraleather



Bed Cover

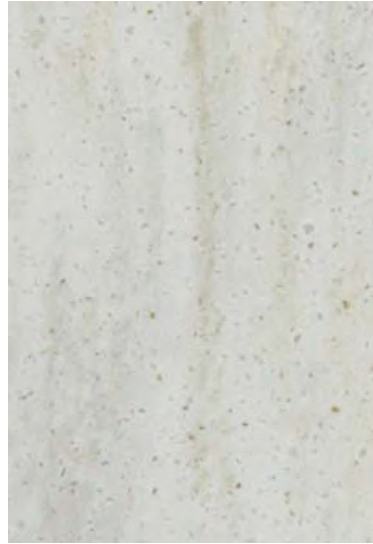

Corian Countertop



Vinyl



Wood

Winnebago® reserves the right to change décor materials and specifications without notice or obligation. Décor is also available online at [WinnebagoInd.com](http://WinnebagoInd.com).

Choose from three fabric collections.

## Masterpiece (70A, 70X)



Ultraleather



Bed Cover

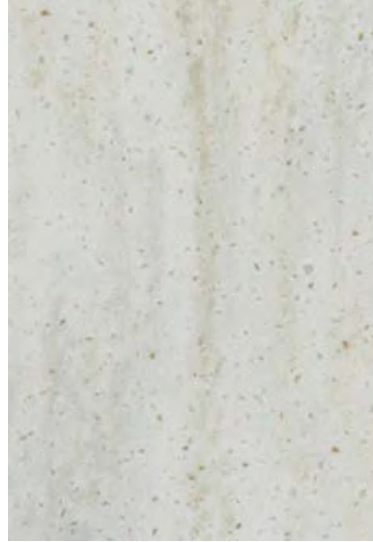

Corian Countertop

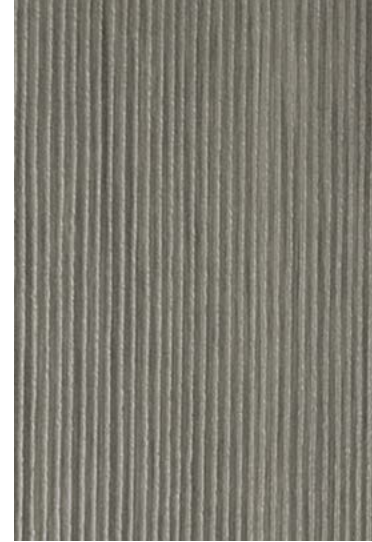

Vinyl



Wood

Winnebago® reserves the right to change décor materials and specifications without notice or obligation. Décor is also available online at [WinnebagoInd.com](http://WinnebagoInd.com).

Choose from three fabric collections.

## Tomoko (70C)

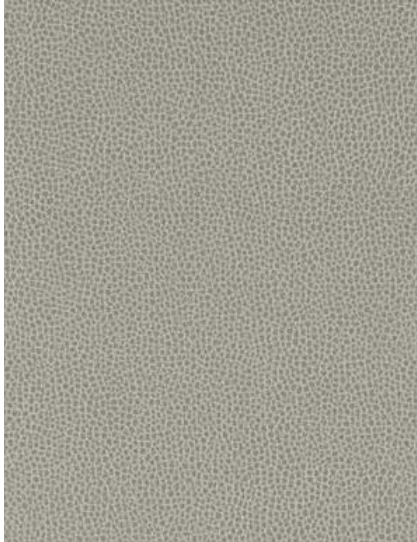

Ultraleather®



Bed Cover



Corian Countertop



Vinyl



Wood

Winnebago® reserves the right to change décor materials and specifications without notice or obligation. Décor is also available online at [WinnebagoInd.com](http://WinnebagoInd.com).

Choose from four stylish full-body paint options.



**Graphite Gray**  
FULL-BODY PAINT



**Graphite Gray Graphics Delete**  
FULL-BODY PAINT



**Brilliant Silver**  
FULL-BODY PAINT



**Brilliant Silver Graphics Delete**  
FULL-BODY PAINT

## Weights & Measures

	70A	70C	70X
Length	24'3"	24'3"	24'3"
Exterior Height <sup>1</sup>	9'6" <sup>A</sup> /9'8" <sup>B</sup>	9'6"	9'6" <sup>A</sup> /9'8" <sup>B</sup>
Exterior Width	6'4"	6'4"	6'4"
Awning Length	13'	13'	13'
Interior Height	6'3"	6'3"	6'3"
Interior Width	5'10"	5'10"	5'10"
Freshwater Tank Capacity <sup>2</sup> (gal.)	28	45	28
Water Heater Capacity (gal.)	2.6	2.2	2.6
Holding Tank Capacity - Black/Gray <sup>2</sup> (gal.)	9.8/26	22/25	9.7/21
LP Capacity <sup>3</sup> (gal.)	16	9.5	16
Fuel Capacity (gal.)	24.5	24.5	24.5
GCWR <sup>4</sup> (lbs.)	15,250	15,250	15,250
GVWR (lbs.)	11,030	11,030	11,030
GAWR - Front (lbs.)	4,410	4,410	4,410
GAWR - Rear (lbs.)	7,720	7,720	7,720
Wheelbase	170"	170"	170"

<sup>A</sup> Standard Chassis    <sup>B</sup> Optional 4x4 Chassis

## Mercedes-Benz® Sprinter Chassis

3.0L 6-cylinder, 188-hp, diesel engine, 5-speed automatic Tip Shift transmission, 220-amp. alternator

4-wheel ABS brakes

Stainless steel wheel liners

Trailer Hitch<sup>4</sup> 5,000-lb. drawbar/500-lb. maximum vertical tongue weight

7-pin wiring connector

Slideroom lock system (70C)

### OPTIONAL EQUIPMENT

On Demand 4WD 3.0L 6-cylinder, 188-hp diesel engine, 5-speed automatic Tip Shift transmission w/Hi/Lo Range, 220-amp. alternator (only available with Brilliant Silver exterior) (70A, 70X)

Stylized chrome wheels

Alcoa forged aluminum alloy wheels

## Cab Conveniences

**Radio/Rearview Monitor System** 6" LCD color touch screen, remote, iPod®/MP3 input, color rear camera

**Chassis/coach battery radio power switch**

**Cab seats** armrests, adjustable lumbar support, adjustable headrest, and slide/swivel/recline

**3-point seat belts**

**Dual airbags**

**Cruise control**

**Power steering** w/tilt wheel

**Power mirrors** w/defrost and turn signal

**Power door locks** w/remote

**Power windows**

**12-volt powerpoints**

**Sunvisors**

**Pleated, sliding front window blinds**

**Folding Privacy Screens** for cab door windows

**Carpet floor mat**

**Appliqué package**

## OPTIONAL EQUIPMENT

**Large Screen Infotainment Center with Rand McNally RV GPS** 6" touch screen color monitor w/split screen function, Rand McNally RV GPS safe & easy routing, tools & amenities, trips & content, turn-by-turn voice guidance, AM/FM radio w/CD/DVD player, handheld remote, SiriusXM™ (subscription not included), iPod®/iPhone® audio integration, Bluetooth™, color rearview camera

**Collision avoidance system** windshield-mounted camera, display monitor, available Bluetooth connectivity

## Interior

**24" HDTV and Coach stereo system** w/AM/FM radio, Bluetooth™, CD/DVD player, remote

**Jack® Digital TV antenna**

**Accent rope lighting** (70C)

**LED ceiling lights** w/dimmer switch

**USB multi-outlet charging station** (70C)

**MCD blackout roller shades**

**Soft vinyl ceiling**

**Tinted coach windows**

**Powered ventilator fan** (bath 70C; galley 70A, 70X)

**Skylight/roof vent** (70C)

**Powered roof vent** (bath 70A, 70X)

**Powered sofa/bed** (70X)

**Removable companion seats w/swivel and slide** (70X)

**Systems monitor panel**

**Multiplex wall switches** (70A, 70X)

**Mirror**

**USB Charger**

### OPTIONAL EQUIPMENT

**Removable storage cabinet** (70X)

## Galley

**Flip-up countertop extension** (70A, 70C)

**Corian® solid-surface countertop**

**Decorative backsplash** (70C)

**Microwave oven** (70A)

**Microwave convection oven** (70C, 70X)

**2-burner range top w/glass cover** (70A)

**3-burner range w/glass top and stainless steel sink w/bamboo cover** (70C, 70X)

**Refrigerator/freezer** (w/removable freezer unit on 70A) (70A, 70X)

**2-door refrigerator/freezer** (70C)

**Stainless steel sink w/folding faucet and glass cover** (70A)

**Cold water filtration system**

## Bath

**Corian solid-surface countertop** (70C)

**Flexible showerhead**

**Shower curtain** (70A, 70X)

**Textured glass shower door** (70C)

**Toilet** w/foot pedal and sprayer

**Skylight** (70C)

**Tissue holder** (70C)

**Towel bar** (70C)

**Towel ring** (70C)

**Stainless steel sink** (70A, 70X)

**Shower with wall surround**

## Bedroom

**Twin beds w/Flex Bed System** (70A)

**24" HDTV** w/remote (70A)

## Exterior

**Side screen door**

**Rear screen door** (70A, 70X)

**Powered patio awning** w/LED lighting

**Slideout compartment tray** (access from rear door) (70A)

**Porch light** w/interior switch

**Running boards, rocker trim w/mud guard**

**Rear mud guards**

**Exterior speaker system**

**Rear storage compartment** (70C)

### OPTIONAL EQUIPMENT

**Polished stainless steel rocker panel trim**

## Heating & Cooling System

13,500 BTU low-profile high-efficiency roof air conditioner

Hydronic heating system (70C)

Truma Combi Eco Plus Heating System w/1,700-watt heating element (70A, 70X)

## Electrical System

AC/DC load center/converter

Auxiliary start circuit

Group 31 deep-cycle battery (AGM maintenance free)

Coach battery disconnect system

Dual-battery charge system

45-amp. converter/charger

30-amp. power cord

Exterior TV jack

Exterior AC/DC receptacles

2,500-watt Cummins Onan® MicroQuiet™ LP generator

## OPTIONAL EQUIPMENT

Additional Group 31 deep-cycle battery (AGM maintenance free)

100-watt solar panel/battery charger

## Plumbing System

Exterior Service Center city water hookup/tank diverter valve, drainage valves, sewer hose (w/shut-off 70X) valve and exterior wash station w/pump switch

TrueLevel™ holding tank monitoring system

Winterization Package water heater bypass valve (70A, 70X) and siphon tube

On-demand water pump

12-volt macerator sewage pump (70X)

Permanent-mount LP tank w/gauge

LPG accessory connection

Holding tank flushing system

## Safety

Child seat tether anchors (sofa and companion seats 70X)

LP, smoke, and carbon monoxide detectors

10 BC fire extinguisher

Ground fault interrupter

Daytime running lamps

High-mount brake lamp

## Warranty<sup>5</sup>

12-month/15,000-mile basic limited warranty<sup>6</sup>

1. The height of each model is measured to the top of the tallest standard feature and is based on the curb weight of a typically equipped unit. The actual height of your vehicle may vary by several inches depending on chassis or equipment variations. Please contact your dealer for further information.
2. Capacities are based on measurements prior to tank installation. Slight capacity variations can result due to installation applications.
3. Capacities shown are tank manufacturer's listed water capacity (W.C.) Actual filled LP capacity is 80% of listing due to overfilling prevention device on tank.
4. Actual towing capacity is dependent upon your particular loading and towing circumstances, which includes the GVWR, GAWR and GCWR as well as adequate trailer brakes. Please refer to the Operator's Manual of your vehicle for further towing information.
5. See separate chassis warranty.
6. See your dealer for complete warranty information.

NA Not Available

Not all items available in combination. See dealer for details.

Winnebago's® continuing program of product improvement makes specifications, equipment, model availability, and prices subject to change without notice. Published content reflects the most current product information at time of printing. Please consult your dealer for individual vehicle features and specifications.







Let us host  
your next

# Adventure



[WGOAdventures.com](http://WGOAdventures.com)



Show your Winnebago love  
with high-quality gifts and wearables.



Apparel | Gifts | Parts | Gear

[WinnebagoOutdoor.com](http://WinnebagoOutdoor.com)

Find your style



Connect with Winnebago (Click one of the following)



Like us



Follow us



Watch us

## WinnebagoInd.com Has All The Answers

Visit [WinnebagoInd.com](http://WinnebagoInd.com) on your computer, smartphone, or tablet for the latest product information and updates.

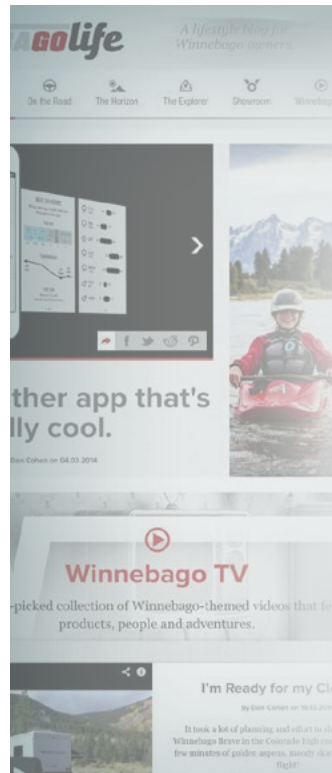

## Welcome to GoLife!

Visit our lifestyle blog for motorhome news, personal travelogues, and community stories.

[WinnebagoLife.com](http://WinnebagoLife.com)

# GoLife

# **PREFERRED CARE PROGRAM**

We back our motorhomes with best-in-class support both before *and* after the sale:



- 12-month/15,000-mile basic limited warranty
- Complimentary 24-hour roadside assistance program
- TripSaver® Fast Track Parts guarantees that in-stock warranty parts ship directly to your dealer within 24 hours
- National dealer service network



For more information, visit us  
[WGOService.com](http://WGOService.com)



From RV to personal insurance, Winnebago RV Insurance can provide all the coverage and services you need to feel at home on the road.

For more information:  
**(800) 642-4892**



## CONTACT US

### GENERAL INQUIRIES

Corporate Switchboard  
(641) 585-3535

### CURRENT PRODUCT OWNER AND SERVICE-RELATED INQUIRIES

(800) 537-1885  
or [winnebagoind.com](mailto:winnebagoind.com)

### NEW VEHICLE SALES INQUIRIES

[sales@winnebagoind.com](mailto:sales@winnebagoind.com)

### FAX

(641) 585-6966

### POSTAL ADDRESS

Winnebago Industries, Inc.  
P.O. Box 152  
Forest City, IA 50436

### STREET ADDRESS

Winnebago Industries, Inc.  
605 West Crystal Lake Road  
Forest City, IA 50436



## Join the Club, Join the Fun

Here's the perfect way to begin your life on the road as the owner of a new Winnebago – by joining the exclusive WIT Club. Start your adventure with other fun-loving WIT Club members from across the country and get the most out of your new Winnebago motorhome.



### Members enjoy:

- Caravans and rallies
- Newsletters
- Local and state group activities
- RV travel benefits

See more at  
[WITClub.com](http://WITClub.com)



## Grand National Rally

Each year, thousands of Winnebago owners descend upon Forest City, Iowa. Rally-goers enjoy an unforgettable week reconnecting with friends, taking tours, participating in activities, and more. Join the adventure next July!



[LaMesaRV.com](http://LaMesaRV.com)  
800-496-8778